

SolarMax Energy Systems

Can the base station battery be connected to the inverter



Overview

Yes, you can attach a small inverter directly to a battery, but doing it safely requires understanding voltage compatibility, wire sizing, and overload risks. Many DIYers assume it's as simple as clipping on cables—until sparks fly or devices fail. How do you connect an inverter to a battery?

Connect the positive cable first. Attach the red cable to the positive terminal on both the inverter and the battery. Attach the negative cable. Connect the black cable to the negative terminal, ensuring secure attachment to prevent loose connections. Always use insulated tools to avoid unintentional contact with live wires.

Do inverters and batteries need to match?

The inverter and batteries must match in terms of voltage, capacity, and power output. If you are using a 12V battery, then the input voltage of the inverter must match the battery voltage. If the specifications of the battery and the inverter do not match, the system will not operate stably and may even damage the equipment.

Do inverters need to be connected to batteries?

Connecting inverters to batteries is an important part of an off-grid power solution or backup power system, and the right connections ensure that the system runs efficiently.

What are inverter battery connections?

Inverter battery connections form the backbone of reliable power systems, ensuring efficient operation and safety. By following best practices and understanding the nuances of these connections, you can enhance system performance and longevity.

What does a battery inverter do?

The inverter is responsible for converting DC (direct current) power stored in

the battery into AC (alternating current) power, which is what most household appliances and electronic devices require to operate.

What type of battery does an inverter use?

Inverters typically use lead-acid batteries, known for their reliability and cost-effectiveness. UPS systems might use similar batteries, but some opt for lithium-ion variants due to their compact size and longer life. Knowing your battery type helps in choosing the right connection method and maintaining overall system health.

Can the base station battery be connected to the inverter



Inverter Battery Connection: Essential Tips For Safe And Efficient

Learn essential tips for safe and efficient inverter battery connection. Discover step-by-step guides, wiring techniques, and troubleshooting tips to optimize your power backup system's ...

[Get a quote](#)

Utilizing the Motoma base station battery in conjunction with the

Unlock the potential of your power setup by following our clear instructions on connecting MOTOMA #LiFePO4 #BaseStationBattery to a #Voltronic inverter using the BMS cable.

[Get a quote](#)



How to Connect a Base Station Lithium Battery to an Inverter A ...

Connecting lithium batteries to inverters in base stations is critical for industries like telecommunications, renewable energy integration, and emergency power systems.

[Get a quote](#)

What Is the Difference Between an Inverter and a Portable Power Station

If you've ever faced a power outage or needed electricity off-grid, you've likely wondered: Should I use an inverter or a portable power station? While both provide backup ...



[Get a quote](#)

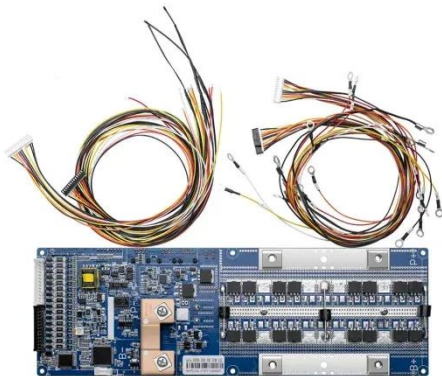

Charging Battery While Connected To Inverter: The Best Way

Power source options How to connect the charging system Following the outlined method below, you can ensure uninterrupted power by charging your battery while connected to an inverter.

[Get a quote](#)

Understanding Battery Capacity and Inverter Compatibility

How Long Can a 100 Ah Battery Run a 1000W Inverter? To estimate how long a battery can run an inverter, we need to consider the power draw and the battery's capacity. ...



[Get a quote](#)

How to connect inverter to battery: a step-by-step ...



Connecting an inverter to a battery is a crucial step in setting up a reliable off-grid power solution or backup energy system. This setup ensures ...

[Get a quote](#)

How to Add Battery Backup to an Existing Grid-Tied ...

There are 3 ways to add solar battery backup to an existing grid-tie system: AC coupling, DC coupling, or replacing your inverter. Click to learn more.

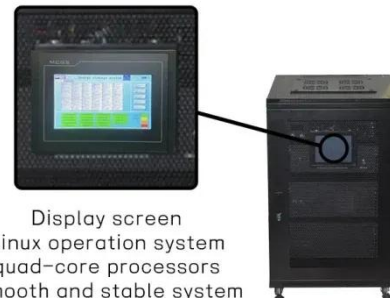

Display screen
Linux operation system
quad-core processors
smooth and stable system

[Get a quote](#)



How to connect inverter to battery: a step-by-step ...

We'll explore how to connect inverter to battery, its purpose, and the tools needed for a proper and safe connection. Connecting an inverter to a ...

[Get a quote](#)

is anyone plugging the base station into an inverter and a battery

Is anyone setting this BASE STATION with a deep cycle battery, and an

inverter? So they can run it for months regardless of any power outage? put a trickle charger and a solar panel on it to ...

[Get a quote](#)



is anyone plugging the base station into an inverter and a battery

I used one of these to power an Eero off a solar panel with a lead-acid battery. It does require the use of a multimeter to set the output voltage, but the benefit is I don't have to worry about ...

[Get a quote](#)

Can I connect an inverter directly to a battery?

Yes, you can connect an inverter directly to a battery bank. Once the batteries are connected correctly, simply route the positive and negative wires from the inverter to the ...

[Get a quote](#)



How to connect inverter to battery: a step-by-step guide for safe ...



We'll explore how to connect inverter to battery, its purpose, and the tools needed for a proper and safe connection. Connecting an inverter to a battery is a crucial step in setting ...

[Get a quote](#)

How to Hook Up a Power Inverter to a Battery

Using the alligator clip, connect the black/negative inverter cable to the black/negative battery terminal Using the alligator clip, connect the ...

[Get a quote](#)



Charging A Battery While Using An Inverter: Tips For DIY ...

Yes, you can charge a battery while using an inverter. The inverter connects the solar panels, battery, and electrical load. This setup allows energy to flow from the solar ...

[Get a quote](#)

Installing an inverter in your home to keep the lights on

Therefore, the inverter plays a crucial role in ensuring the energy stored in the

batteries can be used to power our household appliances. What Size Inverter Do I Need? If ...

[Get a quote](#)



Utilizing the Motoma base station battery in conjunction with the

Unlock the potential of your power setup by following our clear instructions on connecting MOTOMA #LiFePO4 #BaseStationBattery to a #Voltronic inverter using the BMS ...

[Get a quote](#)

How to Safely Connect a Battery to an Inverter: A ...

Learn how to safely connect your batteries to your inverter with our guide. Avoid common wiring mistakes to optimize performance and extend ...

[Get a quote](#)



is anyone plugging the base station into an inverter and a battery

I used one of these to power an Eero off



a solar panel with a lead-acid battery. It does require the use of a multimeter to set the output voltage, but the benefit is I don't have to ...

[Get a quote](#)

Maximize Your Inverter's Potential: Can a Car Battery be the ...

Key points In the realm of electrical ingenuity, the question of whether a car battery can power an inverter has sparked curiosity among many. However, it's important to ...



[Get a quote](#)



Beginner question for battery to inverter connections

The interconnecting cables between batteries making the parallel connections need to be the same gauge as the feed cables to the inverter. The interconnecting cables between ...

[Get a quote](#)

Can We Start A Car With An Inverter Battery? Risks And How To Connect

You should not start a car with an inverter battery. Car batteries provide high starting current for a short time. Inverter batteries deliver continuous current but lack the burst ...

[Get a quote](#)



LPW48V100H
48.0V or 51.2V



Can I Attach My Small Inverter Directly to the Battery?

Yes, you can attach a small inverter directly to a battery, but doing it safely requires understanding voltage compatibility, wire sizing, and overload risks. Many DIYers assume it's ...

[Get a quote](#)

How the Base battery works: A complete guide to grid ...

Inverter: The smaller white unit next to the battery cube contains the inverter. The inverter changes alternating current (AC) from the grid into direct current (DC) for storage.

[Get a quote](#)



Inverter Transformer and its Working Principle

Inverter transformers are used for a wide variety of industrial applications. As the name suggests, the inverter

transformers combine the ...

[Get a quote](#)



How the Base battery works: A complete guide to grid ...

Inverter: The smaller white unit next to the battery cube contains the inverter. The inverter changes alternating current (AC) from the grid into direct current (DC) ...



[Get a quote](#)



How to Safely Connect a Battery to an Inverter: A Step-by-Step ...

Learn how to safely connect your batteries to your inverter with our guide. Avoid common wiring mistakes to optimize performance and extend system life.

[Get a quote](#)

solar power for Base station

The solar power for base station solution provides an economical and efficient energy solution for communication base

stations, reducing operating costs, emissions, and improving energy ...

[Get a quote](#)



Inverter Battery Connection: Essential Tips For Safe And Efficient

A well-connected inverter battery ensures that power flows efficiently, reducing energy loss and preventing potential hazards. Incorrect connections can lead to malfunctions, reduced battery ...

[Get a quote](#)

Contact Us

For catalog requests, pricing, or partnerships, please visit:
<https://zenius.co.za>